

OUTLINE DRAWING:

RECOMMENDED PCB LAYOUT

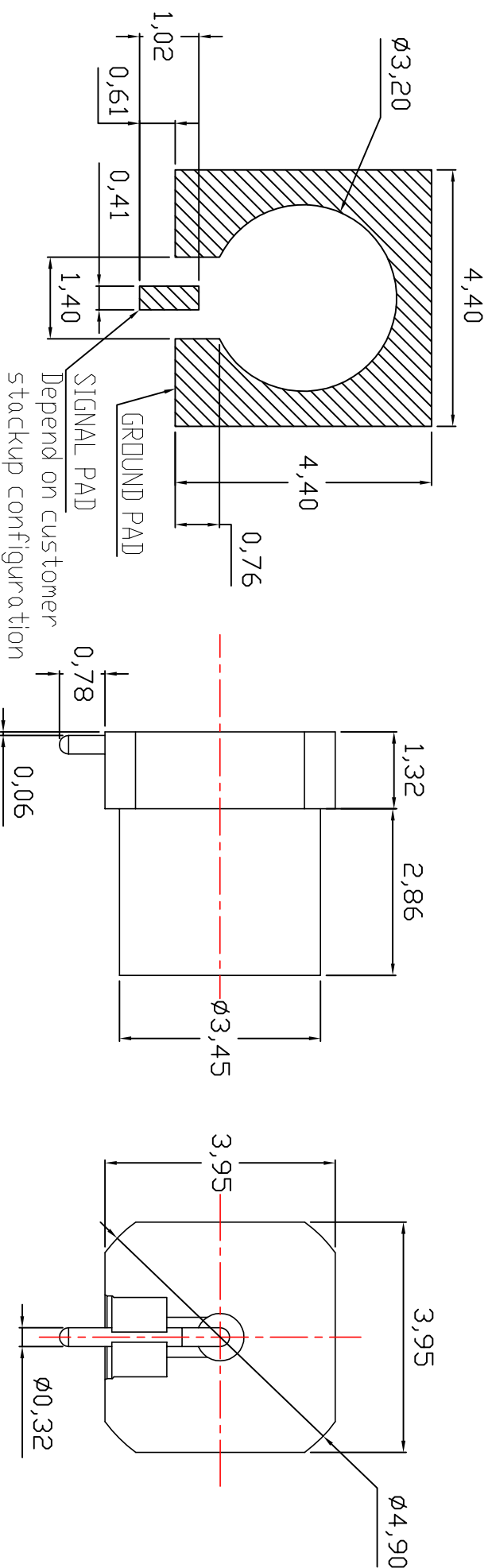

Above Pcb layout is for reference only, the trace impedance depends on pcb material, stackup, customised trace and so on. It is necessary to make a SI analysis before use this pcb layout

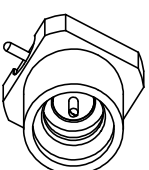

- NOTE:
1. IMPEDANCE: 50 OHM
 2. FREQUENCY RANGE: DC~60GHZ
 3. RETURN LOSS: ≥ 15 dB @60GHZ
 4. INSERTION LOSS: $0.05 \times \sqrt{f}$ (F IN GHZ)
 5. WORKING VOLTAGE: 500 VRMS
 6. INSULATION RESISTANCE: $\geq 5G\Omega$
 7. OPERATING TEMP: $-40 \sim +155^{\circ}C$

BODY	BRASS	GOLD PLATING
DIELECTRIC	PEEK	NATURAL
CENTER CONTACT	BECCU	GOLD PLATING
DESCRIPTION	MATERIAL	FINISH

REV	DESCRIPTION	DRAWN BY	APPROVED BY	DATE
A	FIRST ISSUES	FAN		26-07-2021

DIMENSION:	MM	SERIES:	SMPM	CABLE:	N/A
General tolerance Unless Otherwise specified					
0 Plance:	± 0.2	DRAWN:	FAN	26-07-2021	
1 Plance:	± 0.2	CHECKED:	FAN	26-07-2021	
2 Plance:	± 0.2	APPROVED:			
Angles:					
CUSTOMER DRAWING					
This drawing is a controlled document					
PART NUM:					
DRAWING NUM:					
SCALE: N/A					
REMARK:					
PAGE: 1/1					

DesignCon

Title: DSK SMPM-60GHZ